

<p>3.1 WC indicated that the project has taken over 20 years and because Medupi PowerStation is failing their inspections, He advised that Medupi Power Station maybe closed by the time the MCWAP 2A project is completed. He advised that different options should be considered. DE responded by saying that the DWS has conducted several studies and have considered the different options and thus far this is the best option.</p> <p>3.2 WC requested timelines on the completion of the construction and if not completed on time will there be penalties? SD advised that when the Contractor is appointed, and expropriation is completed the Landowners will timelines to be provided with timelines.</p> <p>3.3 WC indicated that he prefers the Western Alternative, as it doesn't bypass his farm. DE noted the preference and indicated that it will be taken into consideration with the inclusion of Eskom.</p> <p>3.4 JS preference was the Eastern Alternative.</p>		
<p>4. <u>WAY FORWARD</u></p>		
<p>DE advised that the Basic Assessment Report will be circulated for formal comments.</p>		

ANNEXURE A
MCWAP-2A HLRM MAP

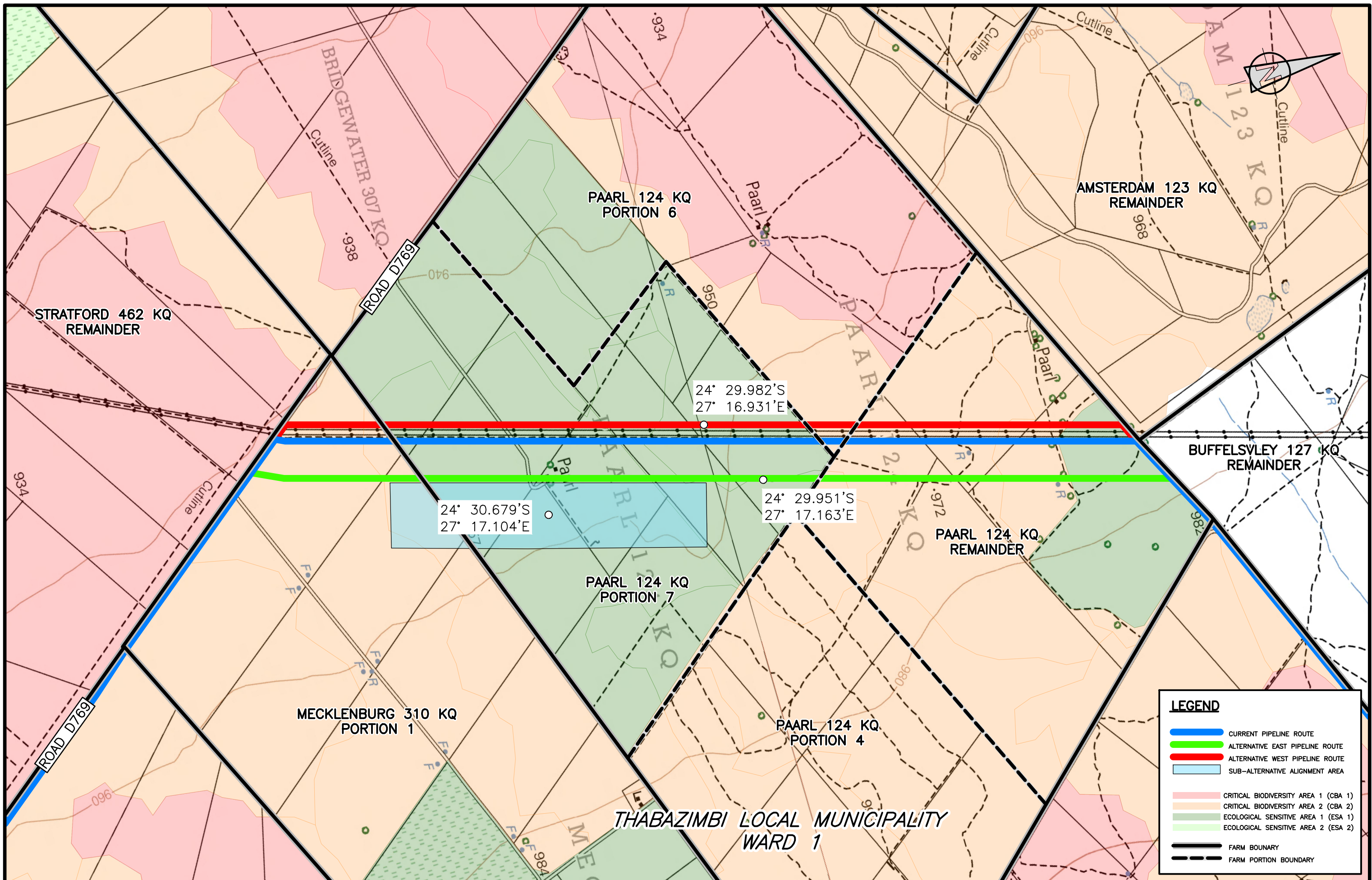

MOKOLO CROCODILE WATER AUGMENTATION PROJECT PHASE 2 (MCWAP-2)

ANNEXURE B
ATTENDANCE REGISTER

